



INTERSTATE® BRICK



Nothing Else Stacks Up!



Genuine Clay Pavers

Interstate Brick: Paving the Future!

Paving Brick - For the distinguished look in landscaping and ultimate sustainability, nothing compares with genuine clay pavers. Outstanding physical properties make clay brick pavers an excellent choice for driveways, plazas and patios. Clay brick pavers come in a variety of sizes and colors and can be laid in a wide range of patterns. Bullnosed pavers are also available to finish the edges of pools, stair treads and courtyard walls.

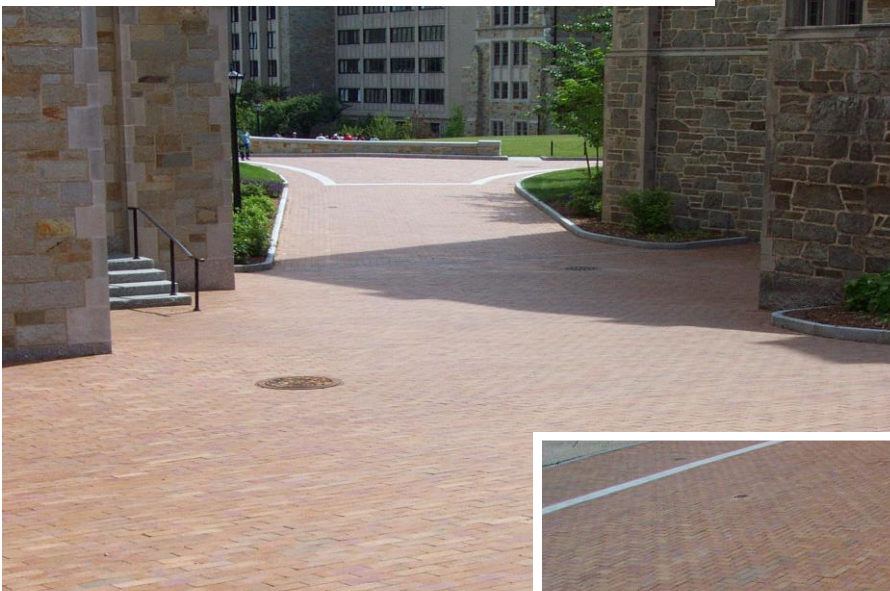

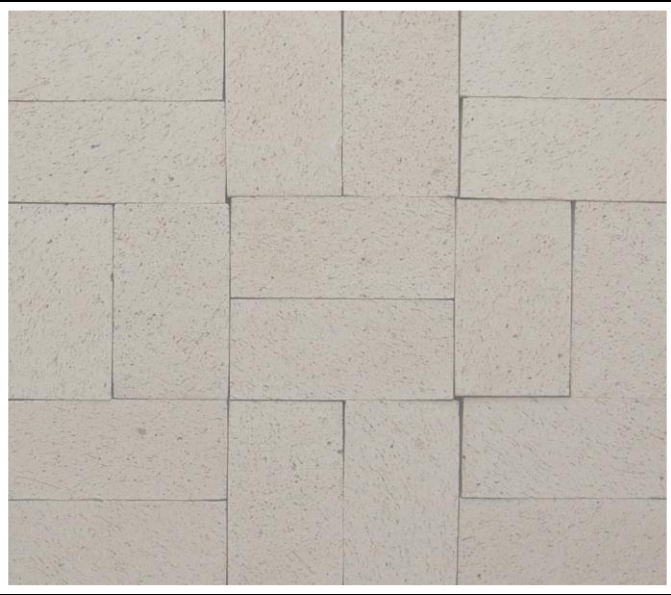

Glacier Mist



Ebony



Golden Buff



Smokey Mist



Caramel



Mojave Brown



Bronzecreek



Terra Cotta



Primrose



Cherry Red



Cast Iron



Bronzecreek Lugged

Lugged Pavers

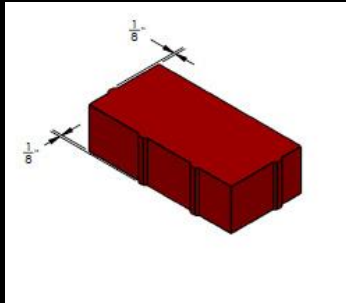

Dimensions

- 2-1/4 x 4 x 8
- 2-5/8 x 4 x 8
- 2-1/4 x 3-5/8 x 7-5/8
- 2-5/8 x 3-5/8 x 7-5/8

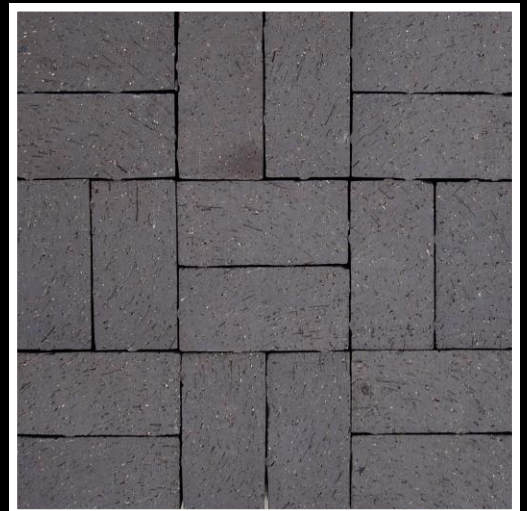

Ebony Lugged

Notes: Lugs can be placed on all colors of 2-1/4" and 2-5/8" thickness pavers.

Specify 1/4" Lugs for permeable applications.

The printed colors shown in this brochure may vary from actual brick samples.
We recommend color selection be made from actual brick samples.

Clay Paving Bond Patterns



Running Bond



Single Basket Weave



Double Basket Weave



Running Weave



Herringbone



Stack Bond



Cherry Creek Cobble



Ebony Cobble



50/50 Blend



Bronzecreek Cobble



Cast Iron Cobble



50/50 Blend

**Notes: All brick Colors shown can be cobbled and blended for an additional charge.
The printed colors shown in this brochure may vary from actual brick samples.
We recommend color selection be made from actual brick samples.**

Specifications: Heavy Vehicular / Light Vehicular / Pedestrian Pav-

ASTM C1272 Type F, Application PS

ASTM C902 Class SX, Type I

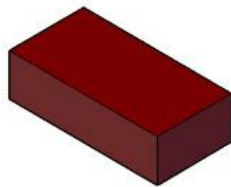

4"x 8" Full

- 2-1/4 x 4 x 8
- 2-5/8 x 4 x 8
- 2-1/4 x 3-5/8 x 7-5/8
- 2-5/8 x 3-5/8 x 7-5/8

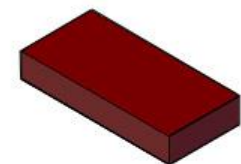
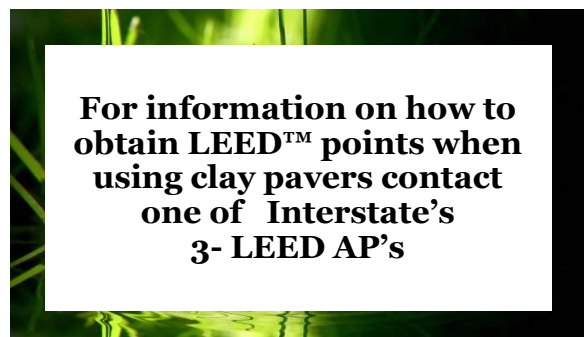

4"x 8" Split

- 1-1/4 x 4 x 8
- 1-1/4 x 3-5/8 x 7-5/8

Use 2-5/8" thickness pavers for Heavy Vehicular traffic over flexible base.



INTERSTATE® BRICK

A Division of PABCO Clay Products

© Interstate Brick 2010

9780 South 5200 West
West Jordan, Utah 84081-5625
(801) 280-5200

www.interstatebrick.com