

# MAC

METAL ARCHITECTURAL

## Installation guide

HARRYWOOD &  
HARRYWOOD BLOCK

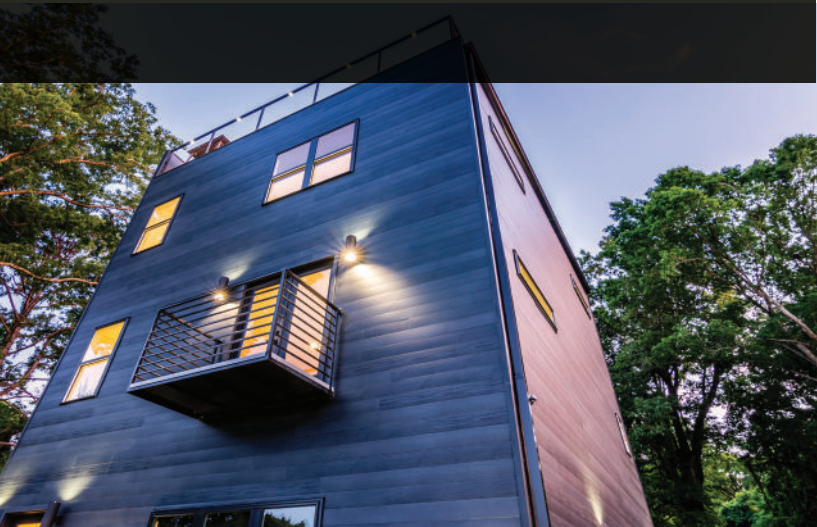

THE BEAUTY AND  
RICHNESS OF WOOD  
without the maintenance!

## PROTECTION

The material may have sharp edges. We recommend using protection equipment, including safety boots, helmet, goggles and gloves.



## WARRANTY

FOR THE WARRANTY TO BE APPLICABLE, INSTALLATION MUST BE CARRIED OUT IN ACCORDANCE WITH THE STANDARDS SET OUT IN THE UPDATED BUILDING CODE, ALONG WITH THE MANUFACTURER'S RECOMMENDATIONS.

In the event that a problem occurs during the installation of the profiles, it's important to notify the supplier before the installation of 144 sq. ft. (2 boxes), to make sure that the warranty will apply. Over 144 sq. ft., the responsibility for the installation lies on the installer.

## INSPECTION

When you receive your order, it is important to inspect the product immediately. If there are any issues with your order or if panels arrive damaged, you should inform your supplier as soon as possible.

## HANDLING

Handle the box with care, ensuring to move it without bending the contents.



## STORAGE

To keep the aesthetic and physical properties of MAC Metal Architectural's Harrywood metal siding intact, it is important to follow some basic rules for storage.

If the panels cannot be installed immediately upon delivery, store them indoors in a dry, well-ventilated area. Customers are responsible for the risks involved in storing panels outdoors. However, if the material must be stored outside, here are a few recommendations:

Place the panels in an area with no direct exposure to the sun or to extreme temperatures, as these factors may cause the protective coating to further adhere to the panels. This can make the coating more difficult to remove and leave glue marks on the panels.

We also recommend using a tarp to protect the materials from temperature fluctuations.

## PRODUCT TESTING

- Tested as per CAN/ULC-S135 for use in non-combustible constructions
- Tested in compliance with ASTM E1886 & E1996 standards (MIAMI DADE)
- Tested in compliance with TAS 202 & 203 standards (MIAMI DADE)

## INSTALLATION WARNING



## WINDSTORM ASSEMBLY (MIAMI DADE)

For hurricane-resistant installation according to the ZHLA.63 wall design, be sure to follow the wall construction details below.

On a wall of a house or building of wood construction with 16-inch half-timbering, install as follows:

1. A 5/8 in (15.9 mm) plywood sheet nailed with 2.5-inch long, 0.099-inch diameter nails every 8 inches (203 mm) along its periphery and in the panel.
2. A 12-inch high SOPRASEAL STICK 1100T waterproofing membrane at the wall sill (or equivalent membrane).
3. SOPRASEAL VP PRIMER on the plywood plank and waterproofing membrane (or equivalent primer).
4. SOPRASEAL VP self-adhesive vapour barrier membrane on the plywood plank. The self-adhesive side of the membrane is covered with a removable film (or equivalent membrane).
5. Wood furrings of 1 in x 3 in (19 mm x 64 mm) at 16-inch (406 mm) intervals using 0.099-inch by 2.5-inch diameter nails.
6. HARRYWOOD/MS14 cladding including: starter molding, finish moldings, J and MS14/ HARRYWOOD panels using MAC screws for cladding every 16 inches (406 mm).

## ZIP R-SHEATHING

**Installation of the MAC siding products on ZIP R-sheathing panels and other dual composite panels with a softer material than wood is not recommended. This type of panel doesn't offer a good rigid mounting surface for the MAC products and will allow for movement and deformation under varying weather and sun exposure transferring into oil canning.**

## WOOD COLLECTION

The Harrywood collection includes six planks with varying grains and nuances. Please ensure that the planks are installed in random order. Each plank is stamped on the reverse side with a number from 1 to 6 in bold type preceded by the pound sign. If you pay particular attention to this when installing the siding, you will undoubtedly optimize the look of your project. In addition, do not put planks in numerical (i.e., 1, 2, 3, ...) order. It is recommended to mix the numbers in random sequences to obtain an optimal result.

\*Please note that the boxes come pre-mixed and that each contains twelve 12-foot planks, for a total of 72.75 sq. ft.

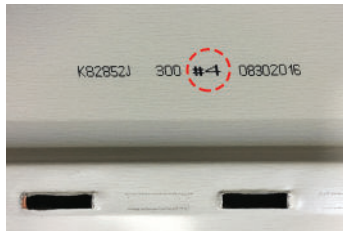

## 1. TOOLS

To complete the work correctly, you will require a MAC cutter, a MAC metal folder or a pair of folding tongs, a drill, and a pair of sheet cutters. You will also need a level, a tape measure, and safety goggles. MAC Metal Architectural equipment is available at the MAC supplier nearest you.

The screws must conform to ASTM B117-2000h. The use of MAC Anticorrosion Wood Screws or K-LATCH MAC Anticorrosion Screws (1 1/8 or 2 1/2 inches), or screws designed for these profiles, is highly recommended by the manufacturer.

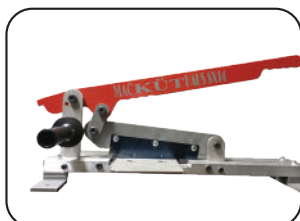



## 2. ACCESSORIES

Here is a list of accessories required to install and finish Harrywood siding:

- MAC wood screws or metal screws, depending on the type of project
- MAC waterproof membrane, if hurricanes are frequent
- Adhesive elastomeric membrane
- Steel roll\*
- Moldings
- Anti-intrusion grid

\*Steel rolls can be provided for finishing work

### PANEL FEATURES

- A. There is memory foam in the back
- B. 0.16"-wide screw rail along the entire length of the structure
- C. 3/4" holes for screws, with 2.36" between each hole (center to center).

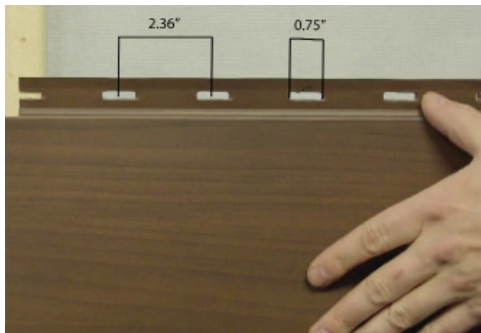

## 3. PREPARATION

Before beginning the first step, ensure that the construction of the surface to be covered with Harrywood siding complies with all current industry standards.

Please check with your local authorities regarding the installation of metal or wood furring. If they are not needed, then it's okay not to install them.

Also, make sure to refer to the building code of your province.

## HARRYWOOD TRIM & FLASHING

**No. M10SHW (Harrywood)**  
Starting Strip

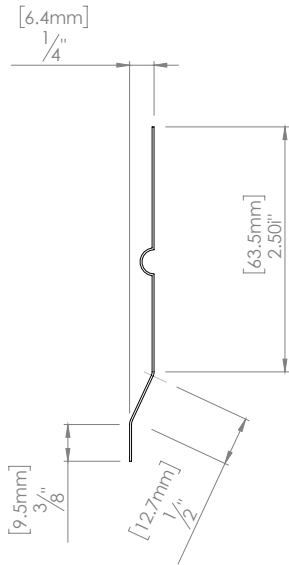

**No. M50CD (Harrywood,  
MS 14 & Norwood)**  
Flashing drip

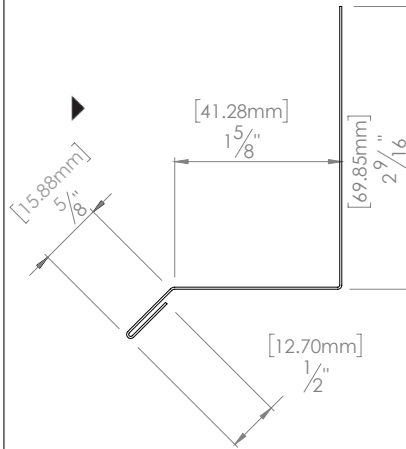

**No. M53CD (Harrywood,  
MS 14 & Norwood)**  
Double Flashing drip

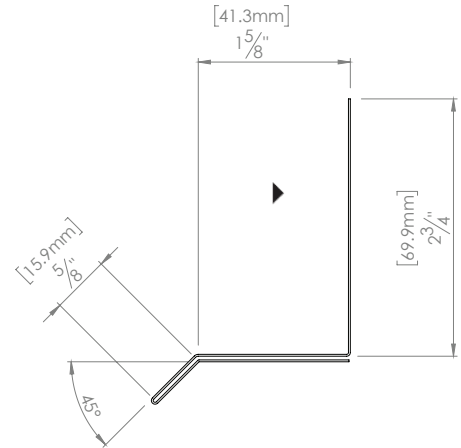

**No. M56CD (Harrywood,  
MS 14 & Norwood)**  
Extended drip flashing w/variable

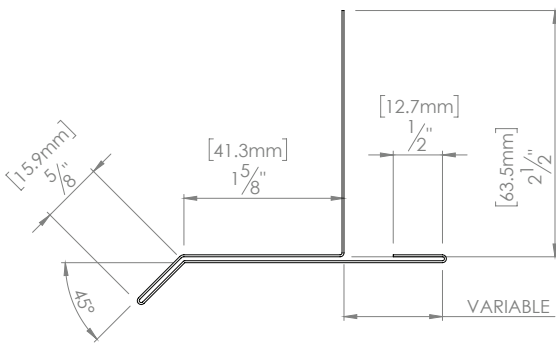

**No. M22C (Harrywood & MS 14)**  
Inside corner or QJ

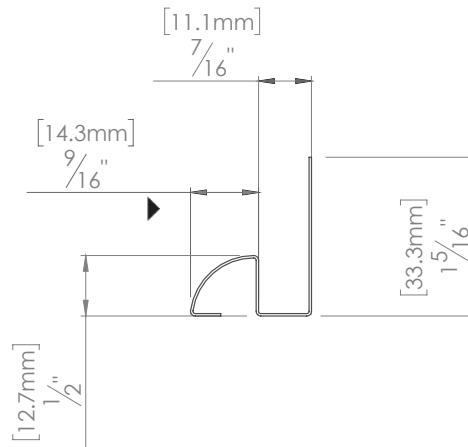

**No. M14CD (Harrywood,  
MS 14 & Norwood)**  
L Trim

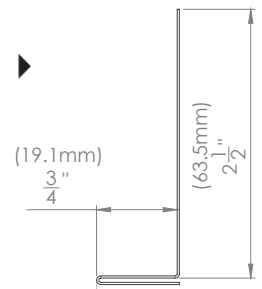

**M20C**  
Outside corner (2 pieces)

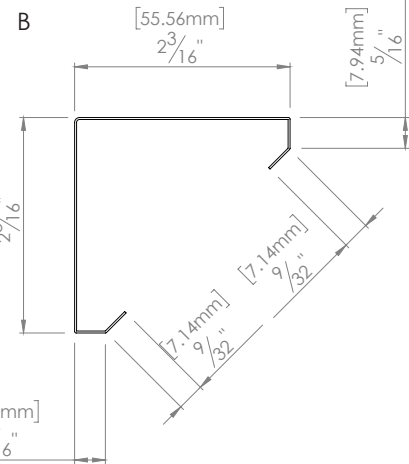
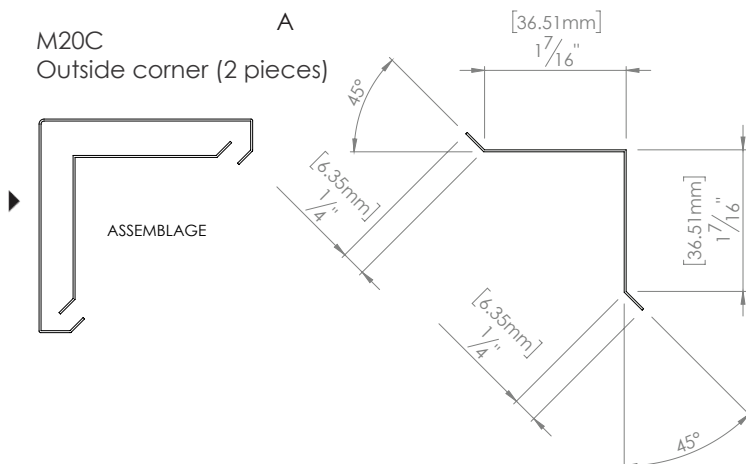

## HARRYWOOD TRIM & FLASHING

### No. M01C (Harrywood & MS 14)

J trim

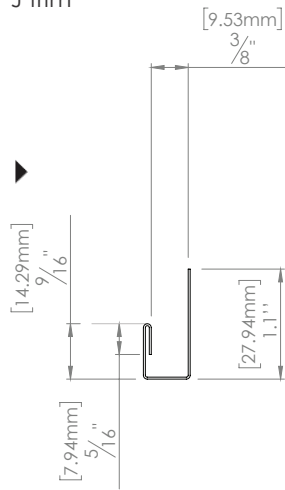

### No. M12C (Harrywood & MS 14)

Vertical transition trim (2 pieces)

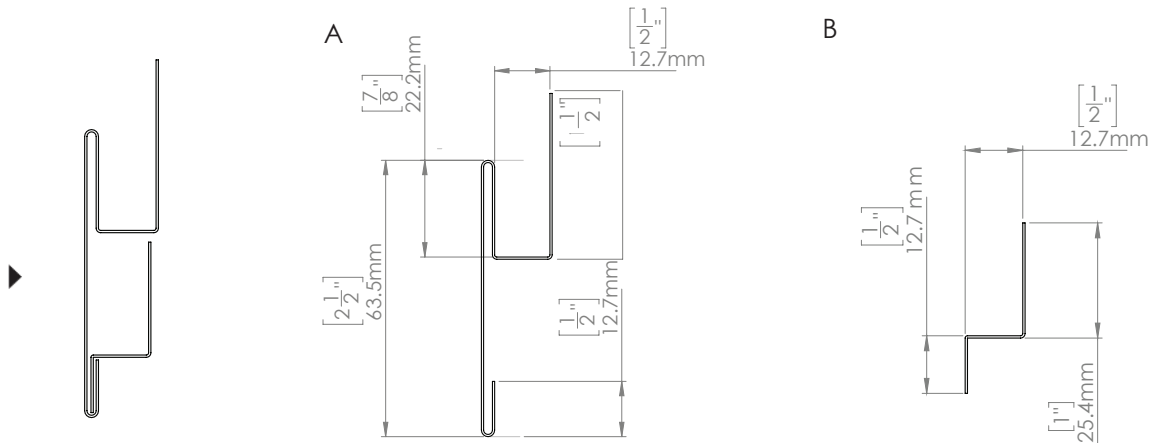

### No. M13C (Harrywood & MS 14)

Horizontal transition trim (2 pieces)

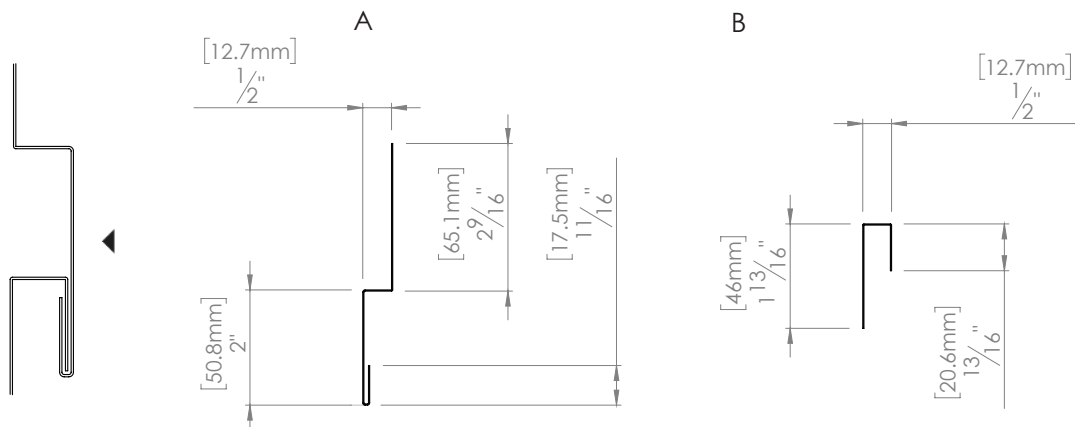

## 4. INSTALLATION

Before beginning to install the siding, ensure that your walls are square and level.

Harrywood wall siding can be installed horizontally, vertically, or diagonally.

### 4.1 Starter Strips

Using a laser-guided level, a chalk tracer or a standard level, trace a reference line as a guide to ensure the starter strip is in place.



Now, fix the M10SHW starter strips 3 inches above where you want your wall to begin. Use flathead MAC Anticorrosion Wood Screw or K-LATCH MAC Anticorrosion Screw (1 1/8 in or 2 1/2 in). Secure the strip using one screw. When you'll be level, screw it in place.

\*\*Ensure that the starter strip is level, as it will serve as a guide for the rest of the installation.





## 4.2 Screws

Tighten screws by applying moderate pressure to the metal to allow expansion. Screws should not be placed under upward or downward pressure to avoid deforming the siding and/or opening the joints.

\*Screws should be installed every 16" or 24" in the middle of the pre-cut holes, to allow expansion.

### SCREWING

Use the MAC Anticorrosion Wood Screw or K-LATCH MAC Anticorrosion Screw (1 1/8 or 2 1/2 in) depending on the type of furring or surface to be fastened. The screws should be set with moderate contact on the clip part of the panel to avoid impeding the expansion of the metal. The screws must not exert any upward or downward pressure to avoid deforming the siding or opening the panels at the joints. A systematic check of the work must be done for every three or four panels placed in height so as to detect possible anomalies. Remove the protective film from the siding prior to installation to facilitate a good visual inspection of the quality of the installation and in order to make appropriate corrections as installation progresses.



A059.250



A060.250



If a section of furring strip appears to not be aligned, we recommend leaving some space between the wall and the furring strip of the metal siding once the screw has been inserted. This will avoid placing too much pressure on the product, which can cause an undesired effect.



### 4.3 Plastic membrane

Wherever possible, only remove the plastic membrane once the installation is done.



### 4.4 Cutting

If you need to cut the panels, use the specialized MAC Guillotine especially designed for Harrywood siding and recommended by MAC Metal Architectural. You can also use, if needed, a snip or a sheer.

\*The use of an electric saw or an electric grinder is not recommended or covered by MAC Metal Architectural warranty.



### 4.5 Joints

Only factory cuts should be used for wall joints, and cutting on site should only be done for wall moldings.

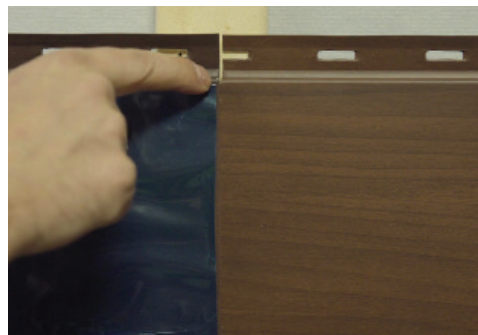
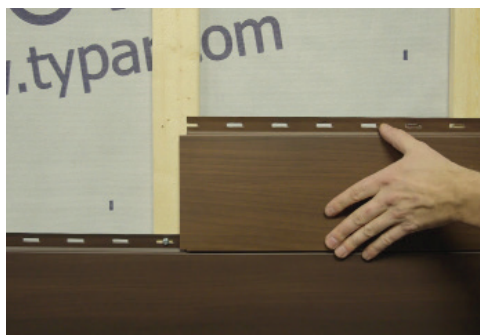

## 4.6 Expansion

At the cross joint of the panels, a space must be provided for expansion or contraction of the material depending on the temperature during installation. A 1/8- to 1/4-in space must be provided between two female panels.

In the case of a new wood building with more than one storey, it will be necessary to provide a transition molding on each floor; on a steel structure, install a transition molding every 30 ft. In the case of a very long wall, it is recommended to install a vertical transition molding every 30 ft.

## 5. INSIDE CORNER

### 5.1 L steel corner

Apply an L-shaped steel wedge directly to the weather barrier and/or the furring.



### 5.2 QJ Trim inside corner

Proceed with the installation of the siding on one of the walls, fix in place the QJ Trim for the interior corner, M22C. Continue with the installation of the panels, making sure to leave a 1/8-in space for material expansion on the other wall by sliding the planks at the end of the QJ molding inside corner.



## 6. OUTSIDE CORNER

Outside molding corner M20C should be installed in two steps:

### 6.1 Step 1, Corner molding

After installing the facings on the two walls forming a corner, attach the fastening molding with screws over the panels and under the horizontal joint of the panels.



### 6.2 Step 2. Finished trim

Randomly apply drops of MAC sealant inside the trim moldings before stapling them in place. Apply a 1-inch wide x 1/4-inch high strip of MAC sealant at 24-inch intervals along the trim.



**\*\*If you do not have an anchor point, you must secure the corner with a screw, then trim and fold back the bottom of the trim to create a surface area to hold it in place.**

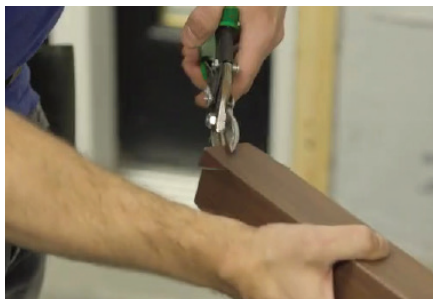



## 7. WINDOW FRAMING

### 7.1 Adjustment

Measure and adjust the plank as necessary before securing it in place.

In case the plank need some adjustment, cut the plank to the height necessary. Then attach the cut-out upside down to give more support to the plank.



### 7.2 Step 2. Soffit J Trim installation

When the wall you are covering has a window, first install the J-Trim molding , M01C on three sides of the window. Then install a molding of drip above the window frame.

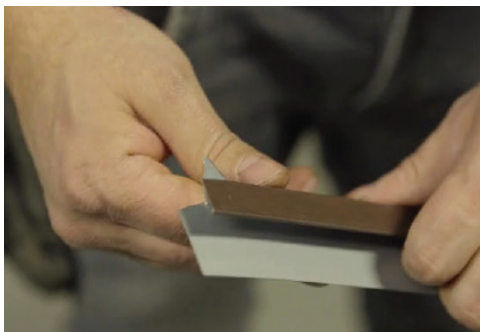



## 7. WINDOW FRAMING

### 7.3 Around the window

Continue with the installation of the panels on each side of the window, taking care to continue to install panels of various shades and tones in a random sequence in order to avoid creating a repetitive effect. Refer to the numbering at the back panels.

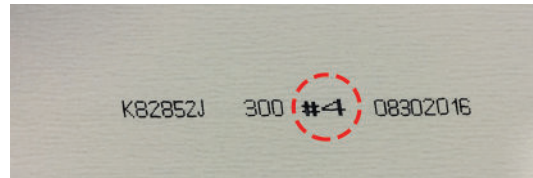

### 7.4 The top of the window

We recommend installing a drip molding before installing the first panel from the top of the window.

In case the panel does not reach the full height, cut the panel, make sure to provide an additional ½ in for a 45-degree bend. Then fix in place the remaining cut trim upside down to provide more support. Then clip the folded panel into the extra piece.

As shown in section 7.2.

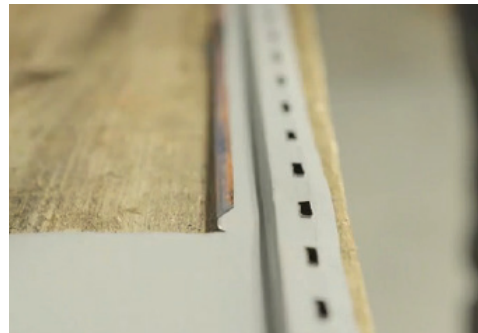

## 7. WINDOW FRAMING

### 7.5 The top of the window



## 8. END OF THE WALL

### 8.1 Adjustment

Measure and adjust the final plank accordingly using an electric shear before attaching it to the J-Trim molding M01C.



If the plank is not flush with the height of the wall, place the extra piece backwards onto the J-Trim molding, M01C to add support to the plank that was cut.



## 8.2 Soffit & J-Trim

Install a J-Trim molding M01C at the top of the wall for installation of the soffit.

Did you know that MAC also offers ventilated soffits for most of its profiles to create a final result that stands out?



## 8. REAR RETAINING BRACKET

### 8.1 Adjustment

The new Harrywood rear retaining bracket is designed especially for large-area installation, where it acts as a support, providing additional reinforcement by tightening the joints. Easy to install – you just insert it on the top of the two boards in the middle of the joint.



## 9. REPLACING PLANKS

It is entirely possible to replace planks. We suggest taking a moment to view the related video under the "Siding" section of our website, at the bottom of the page on Harrywood siding.

## 11. HARRYWOOD BLOCK

### 1. Aligned joint installations

#### 11.1. The aligned installation

Take the measurement between the two ends. When installing between two J Trims, it is recommended to deduct 1/8 of an inch from the full measurement to avoid scratching the board.

For the first sheet, be sure to center the grooves of your sheet so as to obtain an equal measurement after the grooves at the ends.

For your second sheet, take the measurement between the wall and the first groove of the board in place and add 12 inches so that the first groove of the second plank falls 12 inches after the first one.

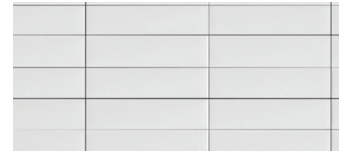

### 2. Offset joint installation

Install the planks, taking care to align all the planks with the grooves.

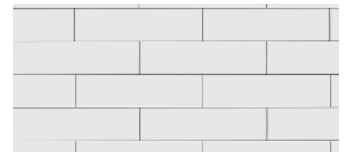

### 3. Breaking bond installation

Take the measurement between the two ends. When installing between two J Trim, it is recommended to deduct 1/8 of an inch from the total measurement to avoid scratching the board. Spread the planks so as to create a staircase effect either by allowing 1 inches space, 11 inches after the grooves of the lower boards.



## SOFFITE INSTALLATION

### 1. PREPARATION

Before taking the first step, make sure that the surface to be covered with the Harrywood profile meets all industry standards in your area.

### 2. INSTALLATION

#### PARALLEL TO-WALL INSTALLATION

Before starting the installation of the soffits, it is recommended, if needed, to install furring to allow the soffit panels to be screwed in place. Furrings installed parallel to the wall will allow this installation to be carried out.

In the case of a soffit installation parallel to the wall, furring must be installed at 6 in center / center, starting with the installation of the first furring from the wall. \*Always ensure that the furring is level.

#### PERPENDICULAR TO-WALL INSTALLATION

In the case of soffits installed perpendicular to the wall, it is recommended, if needed, to install furring at every 16 in c/c to provide adequate support for the boards and avoid stapling problems due to lack of support.

### 3. INSTALLATION OF THE J TRIM

Now apply the J Trim overlapping the last plank of the wall, taking care to fix it on the furring closest to the wall so that it can receive the soffit planks. The boards will be inserted into this J Trim and then fastened to the furring for both installation methods.



#### 4. CUTTING

For both types of installation, measure and cut the pieces using the MAC cutter designed specifically for the Harrywood profile, as recommended by MAC Metal Architectural. It is recommended to support the soffit boards, at least 16 inches center /center, for installations perpendicular to the wall.

\*The use of an electric saw is not recommended by MAC Metal Architectural.



#### 5. JOINTS

When installing the panels parallel to the wall, the ventilation holes of the soffit panels must be folded down at the ends to allow a good fit on the 3/8-inch thick junction block.

In order to create more discrete joints and a continuity effect of the boards when installing parallel to the wall, it is recommended that a 3/8-inch thick engineered wood block be fastened to the furring where the joints meet. The block will then act as a base for the two panels to be joined and will allow the ends of the panels to be screwed onto it.

For non-ventilated joints, do not shim.



## 6. THE FINISH

Once all the boards are installed, the finishing or crowning of the fascia can be done with a custom-bent steel strip. Mac Metal Architectural recommends that installers make the custom molding by double tapping at both ends of the molding. This action will stiffen and help prevent warping of the molding. It is essential, as when installing panels, not to overtighten the molding in place since this could cause indentation and deformation of the molding.



## 7. EXPANSION

At the transverse joint of the panels, remember to leave space for the expansion of the material depending on the temperature during installation. Leave a space of 1/8 in between two female boards and 1/8 in for moldings.



For more information on how to install the Harrywood profile, visit the PRO section of our website, at [MAC-metalarchitectural.com](http://MAC-metalarchitectural.com).

There you will find a bank of technical information on the profile such as a series of installation videos, a moldings catalogue and access to technical drawings.

**MAC**  
METAL ARCHITECTURAL

MAC Metal Architectural Inc.  
3099, Bernard-Pilon (Quebec) J3G 4S5  
T. 450 464-5486 | T F. 450 464-4538  
[info@macmetalarchitectural.com](mailto:info@macmetalarchitectural.com)  
[MACmetalarchitectural.com](http://MACmetalarchitectural.com)